

# SABER TOOTH TRASH DISC ASSEMBLY

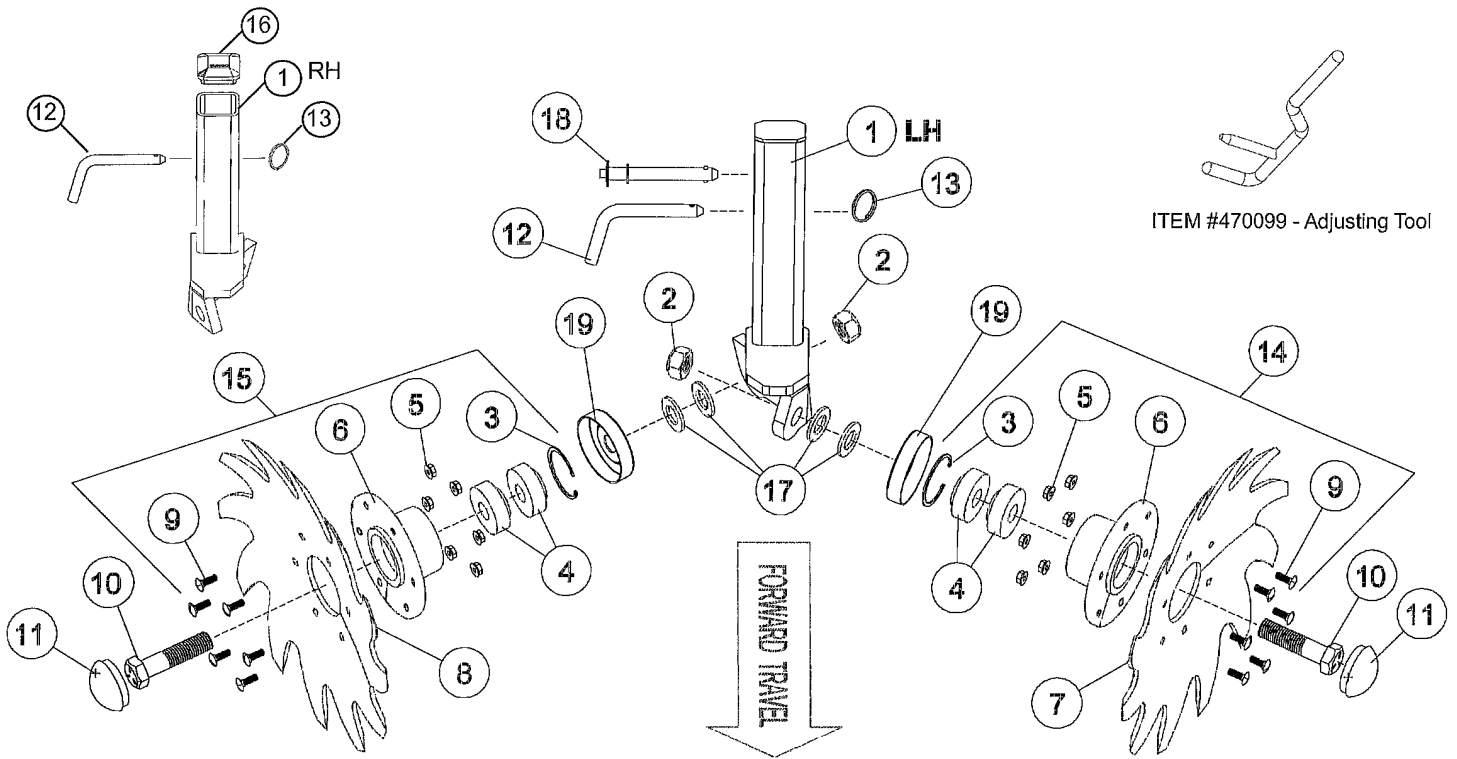

Item	Part #	Description	Qty
1	<b>SEE PAGE 4-2</b>		
2	201152	Nut 3/4 Hex Center Lock	2
3	204385	Snap Ring X 2 Internal	2
4	210030BB	Bearing 2 X .75 BB205KRP2 (JD=A27002)	4
5	201108	Nut 1/4 Flange Whiz Lock	12
6	470417	Hub Kit (Includes 3, 4, 5, 9 & 11)	2
7	166015	Disc Blade 13" Saber Tooth Left	1
	166025L	18" Disc	1
8	166016	Disc Blade 13" Saber Tooth Right	1
	166025R	18" Disc	1
9	200108	Carriage Bolt 1/4 X 1 Gr. 5	12
10	200406	HHCS 3/4 X 3 1/2 Gr. 5	2
11	210089	Hub Cap	2
12	480355 (optional)	Bent Pin	1
13	203141 (optional)	Ring - Kickout 1 1/4"	1
14	3012603	13" Disc-Hub-Bearing Assy LH (incl. items 3,4,5,6,7 & 9)	1
	3012612L	18" Disc-Hub-Bearing Assy LH	1
15	3012604	13" Disc-Hub-Bearing Assy RH (incl. items 3,4,5,6,8 & 9)	1
	3012612R	18" Disc-Hub-Bearing Assy RH	1
16	220027	Plug Rubber 2" Square: <b>Note: May have welded cap (#360021)</b>	1
17	202220	Washer 3/4 Flat SAE Hardened Plated (used with 13" Discs)	4
	360045	Spacer 1.56 OD x .82 ID x .63 (used with 18" Discs - Not shown)	2
18	360205	Pin - Quik Adjust Pin	1
19	360062	Bearing Shield 2.91 x .76	2
	470312	Kit - Bearing Shield (Items 10, 17 & 19) 1 per row	

**FOR PLANTER MOUNT PART NUMBERS - REFER TO PAGE 4-3**

# SABER TOOTH 20/20 TRASH DISC ASSEMBLY 5011208L/R & 5011271L/R

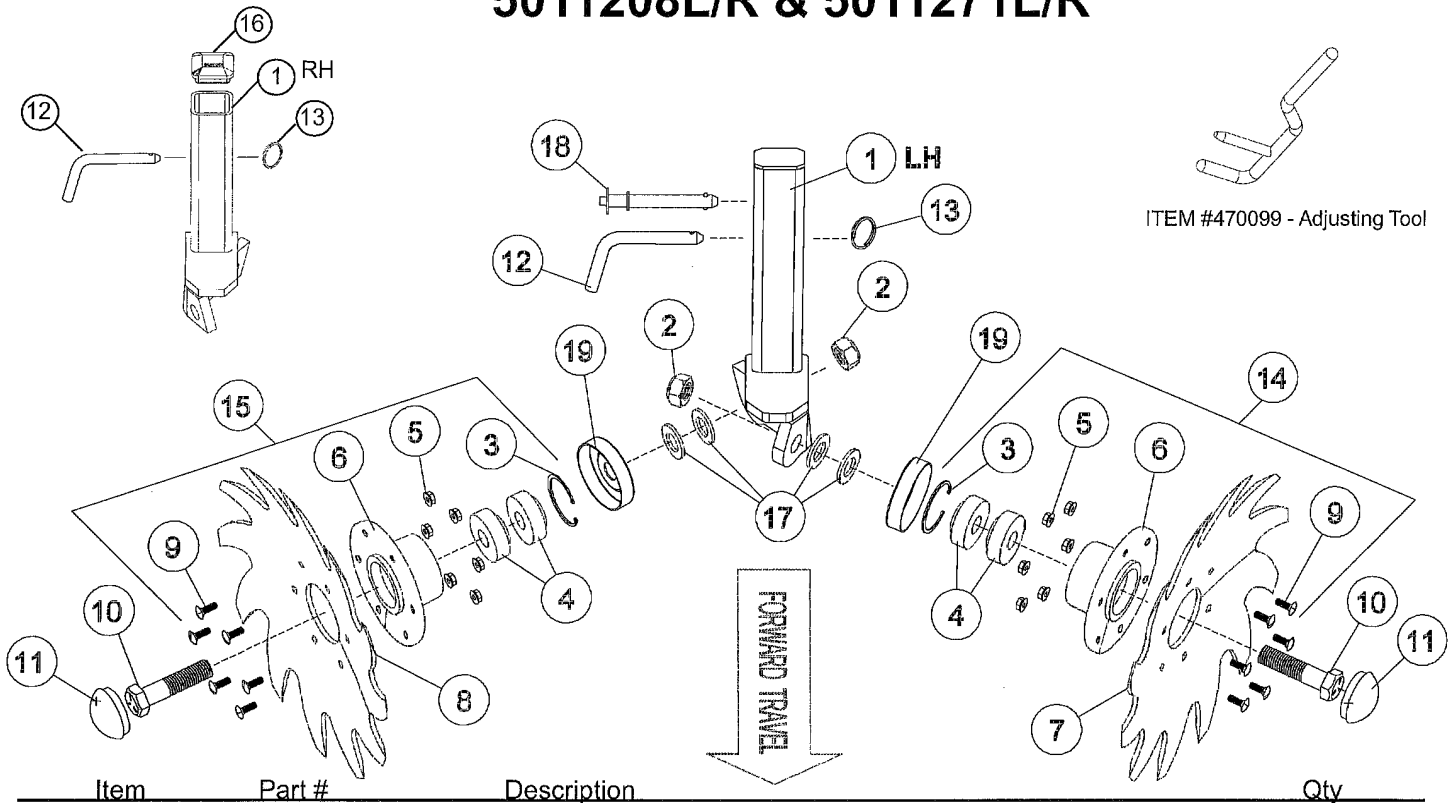

Item	Part #	Description	Qty
1	<b>SEE PAGE 4-2</b>		
2	201152	Nut 3/4 Hex Center Lock	2
3	204385	Snap Ring X 2 Internal	2
4	210030BB	Bearing 2 X .75 205KRP2 (JD=A27002)	4
5	201108	Nut 1/4 Flange Whiz Lock	12
6	470417	Hub Kit (Includes 3, 4, 5, 9 & 11)	2
7	166015	Disc Blade 13" Saber Tooth Left	1
8	166016	Disc Blade 13" Saber Tooth Right	1
9	200108	Carriage Bolt 1/4 X 1 Gr. 5	12
10	200406	HHCS 3/4 X 3 1/2 Gr. 5	2
11	210089	Hub Cap	2
12	480355 (optional)	Bent Pin	1
13	203141 (optional)	Ring - Kickout 1 1/4"	1
14	3012603	13" Disc-Hub-Bearing Assy LH (incl. items 3,4,5,6,7 & 9)	1
15	3012604	13" Disc-Hub-Bearing Assy RH (incl. items 3,4,5,6,8 & 9)	1
16	220027	Plug Rubber 2" Square: <b>Note: May have welded cap (#360021)</b>	1
17	202220	Washer 3/4 Flat SAE Hardened Plated - Lead Disc Only	1
	360045	Spacer 1.56 OD x .82 ID x .63 - Trail Disc only	1
18	360205	Pin - Quik Adjust Pin	1
19	360062	Bearing Shield 2.9 x .76 x .64	2
	470312	Kit - Bearing Shield (Items 10, 17 & 19) 1 per row	

**FOR PLANTER MOUNT PART NUMBERS - REFER TO PAGE 4-3**

# SABER TOOTH 20/20 TRASH DISC ASSEMBLY 5011223L/R for 18" BLADES

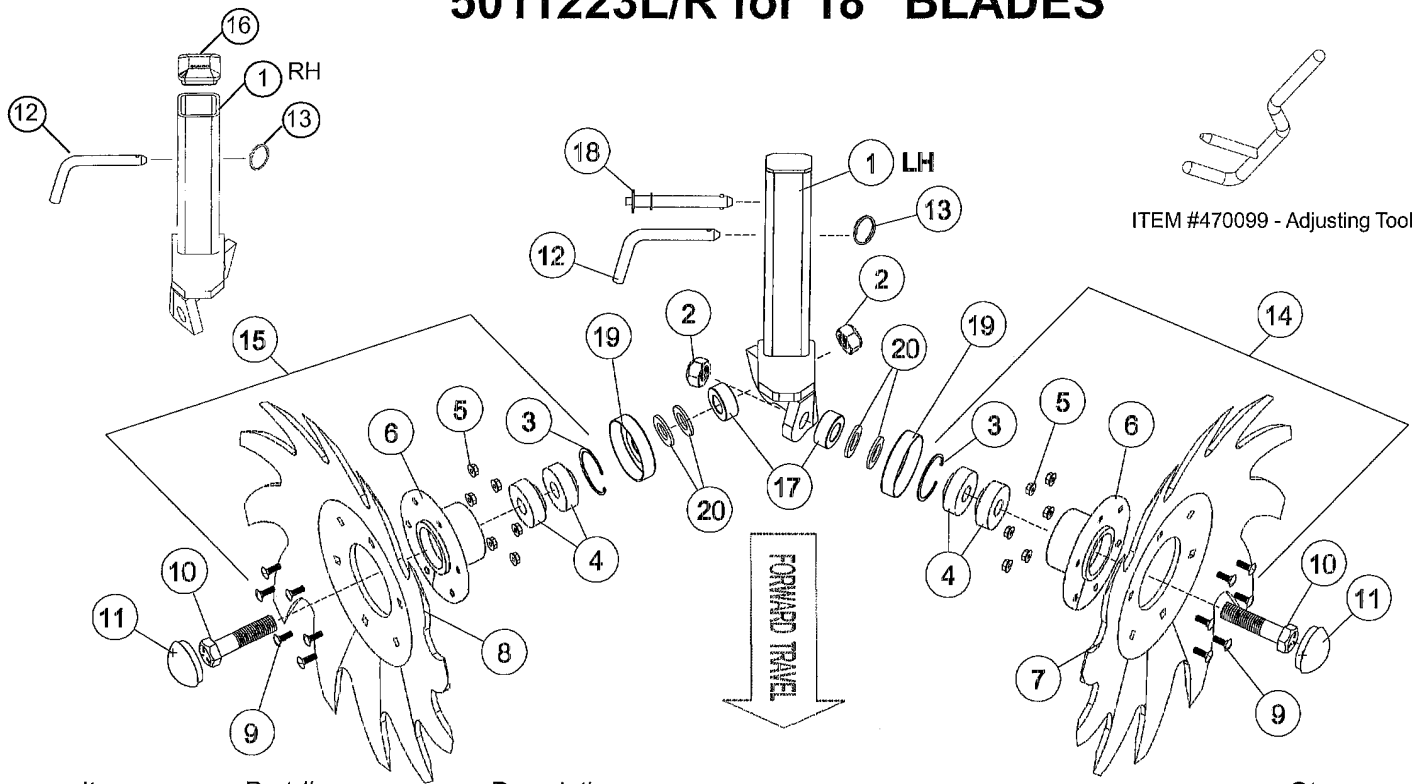

Item	Part #	Description	Qty
1	<b>SEE PAGE 4-2</b>		
2	201152	Nut 3/4 Hex Center Lock	2
3	204385	Snap Ring X 2 Internal	2
4	210030BB	Bearing 2 X .75 205KRP2 (JD=A27002)	4
5	201108	Nut 1/4 Flange Whiz Lock	12
6	470417	Hub Kit (Includes 3, 4, 5, 9 & 11)	2
7	166025L	Disc Blade 18" Saber Tooth Left	1
8	166025R	Disc Blade 18" Saber Tooth Right	1
9	200108	Carriage Bolt 1/4 X 1 Gr. 5	12
10	200407	HHCS 3/4 X 4 Gr. 5	2
11	210089	Hub Cap	2
12	480355 (optional)	Bent Pin	1
13	203141 (optional)	Ring - Kickout 1 1/4"	1
14	3012612L	18" Disc-Hub-Bearing Assy LH (incl. items 3,4,5,6,7 & 9)	1
15	3012612R	18" Disc-Hub-Bearing Assy RH (incl. items 3,4,5,6,8 & 9)	1
16	220027	Plug Rubber 2" Square: <b>Note: May have welded cap (#360021)</b>	1
17	360045	Spacer 1.56 OD x .82 ID x .63	2
18	360205	Pin - Quik Adjust Pin	1
19	360062	Bearing Shield 2.91 OD x .76 ID x .64	2
20	202220	Washer 3/4 SAE Flat	4
	470312	Kit - Bearing Shield (Items 10, 17 & 19) 1 per row	

**FOR PLANTER MOUNT PART NUMBERS - REFER TO PAGE 4-3**